

Alaska Native Plant Society

P.O. Box 8-737 Anchorage, Alaska 99508

JANUARY MEETING--Monday, January 7th at 8PM in Room 108, Bldg. K on the ACC/UAA Campus.

BOARD MEETING--7PM immediately preceding General Meeting listed above. Board members please take note.

MEETING PROGRAM

SPEAKER: Several members of the Society will present highlights of the 1984 Summer Field Trips.

PLANT FAMILY: Discussion, presented by member Lynn Catlin will be on the *Lentibulariaceae* (Bladderwort) family. This family has two genera in Alaska. The *Pinguicula* (Butterworts) are terrestrial plants of very wet places that have a tight rosette of fleshy leaves. The *Utricularia* (Bladderworts) are aquatic plants with inflated bladders. This family has snapdragon type flowers with 2 lips and a hollow spur; and, usually, a globose capsule.

MYSTERY PLANT--Once you know the characteristics of this plant's genus, you will have no trouble identifying it. It is found throughout most of Alaska and Northernmost Canada. It grows at a variety of elevations; in moist woodlands near streams, subalpine and alpine meadows, and in snowbeds in the mountains. The flowers grow singularly on stems arising from a thin horizontal rhizome. The lower portion of the stem is dark-colored and somewhat pubescent (covered with fine hairs). The leaves, which are 3-lobed, divided and toothed (following the characteristics of its family), arise singularly from the rootstock and one circles the stem just below the flower. The flower, which has no petals, consists of 5 to 8 bright yellow pointed sepals and a cushion of stamens. This is one of our early Spring bloomers. What is it???

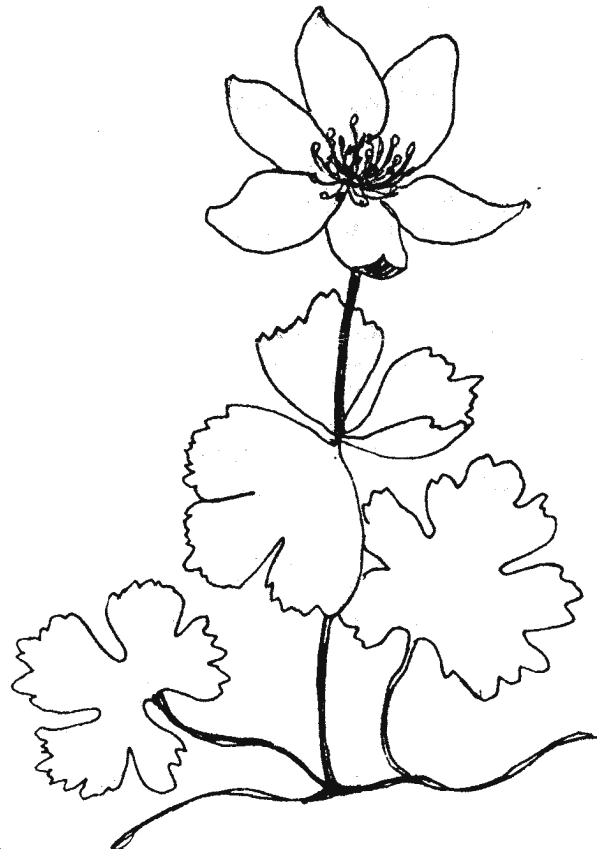

NEWLY-ELECTED 1985-86 STATE OFFICERS AND NEWSLETTER EDITOR ARE:

President-----Verna Pratt-----
Vice-President-----Marilyn Barker-----
Secretary-----Charlu Choate-----
Treasurer-----Larry Haller-----
Newsletter-----Frank Pratt-----

Anchorage Chapter Representative---
Fairbanks Chapter Representative---

WINTER FIELD TRIP--LEADER-Cathy Wright. A Winter ID and walk-thru at the proposed Arboretum site at the corner of Tudor & Basher Roads, Saturday January 12th at 12:15PM. Meet at the SW corner of the parking lot West of Bldg. K on the ACC-UAA Campus (corner of Lake Otis and Providence Drive). Plan on 1 to 3 hours depending on the weather. If you have a hand-lens, be sure to bring it. Be sure to dress warmly and wear boots. If we have sufficient snow, skis or snowshoes may be more appropriate.

SUMMER FIELD TRIPS--We may try a new approach to Field Trips this year in an effort to have sufficient trips and make the best use of our volunteers. In addition to having Field Trips of our own, we will try to coordinate with the State Parks Staff; and, perhaps, volunteer our services to help lead State Parks programs for a better educational experience for all concerned. Volunteers please-----pick your own time and place.

GLEN ALPS SURVEY--The enclosed 1984 Glen Alps Survey is the result of the work of a few volunteers who participated in the study. The consensus of opinion was that the dome at Glen Alps has been almost destroyed by foot traffic because of the fragility of the terrain and its easy accessibility. The Park Service is greatly distressed by the situation, but has no easy answer at present.

UPCOMING CLASSES

PLANT TAXONOMY (with emphasis on Alaskan Flora)--Dr. Marilyn Barker--ACC--3 credit, full semester course--\$60--Tuesday evenings (2 hrs).

ALASKAN WILDFLOWERS--Dr. Marilyn Barker--ACC--4 evening class sessions and 1 full-day field trip in May.

LOTIONS, NOTIONS and POTIONS--by Old Doc--This month's topic is *Impatiens noli-tangere* (Jewel weed). This tall succulent annual plant is found in S.E. Alaska, Southcentral Alaska, the Fairbanks area, and an area West of McKinley Park. It likes wet open woodlands, and blooms in July & August. It has bright yellow flowers with brown spots that look somewhat like a snapdragon flower hanging on a delicate stem beneath its toothed oblong-ovate leaves. The tender young leaves and stems are edible, and its leaves and flowers have been used to make a yellow dye. Its long green seed pods explode spirally if touched when mature, giving it one of its common names of touch-me-not. Its real value of note here is its ability to relieve itching. It has been successfully used on Poison Ivy and Oak to not only relieve the itch, but also to prevent or reduce the swelling. Early pioneers used it in a salve for hemorrhoids, and its juice for ringworm. It is reportedly effective against the sting of *Urtica* (nettle).

It would seem likely that it might be effective on mosquito bites or bee stings. It should not be used internally as it is reportedly harmful to animals.

BOTANICAL	COMMON NAME	MAY 29	JUNE 5	JULY 3	AUG 14	SEP 9
ACHILLEA SP.	YARROW			L	F	
ANEMONE NARCISSIFLORA	NARCISSUS-FLOWERED ANEMONE	F	F	S	L	
ANTENNARIA SP.	PUSSYTOES		F	S	S	
ARCTOSTAPHYLOS ALPINUS	BEARBERRY	F	F	BR	L, BR	A
ARENARIA ARCTICA	ARCTIC SANDWORT	F	F		S, F	S
ARNICA FRIGIDA	ARNICA		B		L	
ARTEMISIA ARCTICA	WORMWOOD	L	L	F	S	S
BETULA GLANDULOSA	GLANDULAR BIRCH	L	L		L	A
BETULA NANA	DWARF BIRCH	L	L		L	A
BETULA OCCIDENTALIS	-----	L	L	FR	L	A
CALAMAGROSTIS SP.	-----			F		
CAMPANULA LASIOCARPA	MOUNTAIN HAREBELL		SE, L	F	F	F, S
CAREX SP.	SEDGE			F		
CORNUS CANADENSIS	BUNCHBERRY, CANADIAN DOGWOOD				L	
CORNUS SUECICA	SWEDISH CORNEL		F, B	F	BR	A, BR
DIAPENSIA LAPPONICA	LAPLAND DIAPENSIA	F	F	S	S	
DRABA NIVALIS	SNOW MUSTARD	F	F, FR	S	FR	
DRYAS OCTOPETALA	MOUNTAIN AVENS	F	F	F, S	S	A
ELYNUS SP.	-----			F		
EMPETRIUM NIGRUM	CROWBERRY	F	F	BR, GR	BR	BR
EPILOBIUM ANGUSTIFOLIUM	COMMON FIREWEED		L	B	F	
FESTUCA ALTAICA	FESCUE	F		F		
HIEROCHLOE ALPINA	ALPINE HOLYGRASS	F				
LEDUM DECUMBENS	NORTHERN LABRADOR TEA		B, F	L	L	
LEDUM GROENLANDICUM	LABRADOR TEA			L		
LINNAEA BOREALIS	TWINFLOWER		L	F		
LLOYDIA SEROTINA	ALP LILY	F	F			
LOISELURIA PROCUMBENS	ALPINE AZALEA	F	F	S	L, S	
LUZULA ARCUATA	ALPINE WOODRUSH	F				
LUZULA PARVIFLORA	BROAD-LEAVED RUSH		F	F		
MINUARTIA ARCTICA (ARENARIA)	ARCTIC SANDWORT	F	F	F, S		
MINUARTIA RUBELLA	REDDISH SANDWORT	F		F		
OXYTROPIS NIGRESCENS	BLACKISH OXYTROPE	F	S	S	BR, S	
PEDICULARIS CAPITATA	CAPITATE LOUSEWORT		F	L, S	L, S	
PEDICULARIS KANEI (SSP. KANEI)	WOOLY LOUSEWORT	F	F			
PEDICULARIS LABRADORICA	LABRADOR LOUSEWORT		F	F	S	
PHLEUM SP.	-----			F		
RIBES DRACIOSUM	TRAILING BLUE CURRANT			BR		
RUBUS ARCTICUS	NAGOONBERRY	F				
RUBUS CHAMAENORUS	CLOYDBERRY	F	F			
RUBUS PEDATUS	TRAILING RASPBERRY		L	F		
SAGINA SP.	PEARLWORT		F		F, S	S
SALIX SP.	WILLOW		F, L	F, S		A, S
SAXIFRAGA BRONCHIALIS	SPOTTED SAXIFRAGE	F	B, F	L	L, S	
SORBUS SP.	MOUNTAIN ASH				BR	
SPIRAEA SP.	SPIRAEA			F		
TOFIELDIA PUSILLA	FALSE ASPHODEL	F	F	F, S	S	S
TRIENTALIS SP.	STARFLOWER			F		
TSUGA MERTENSIANA	MOUNTAIN HEMLOCK		C		C	
VACCINIUM MEMBRANACEUM	MOUNTAIN BLUEBERRY		F		BR	
VACCINIUM ULIGINOSUM	BOG BLUEBERRY	F	F		BR	
VACCINIUM VITIS-IDAEA	LOWBUSH CRANBERRY		B, F	F	BR	A, BR

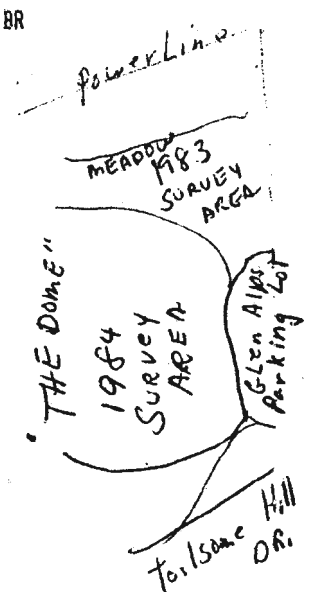

PLANT GROWTH CODES
 B-BUDS BR-BERRIES C-CONES
 F-FLOWERS FR-FRUIT L-LEAVES
 P-PLANTS S-SEEDS SE-SEEDLINGS
 R-ROOTSTALKS CA-CAPSULE

COLOR CODES
 B-BLUE BR-BROWN GR-GREEN
 L-LAVENDER M-MAROON
 O-ORANGE P-PINK PR-PURPLE
 W-WHITE Y-YELLOW

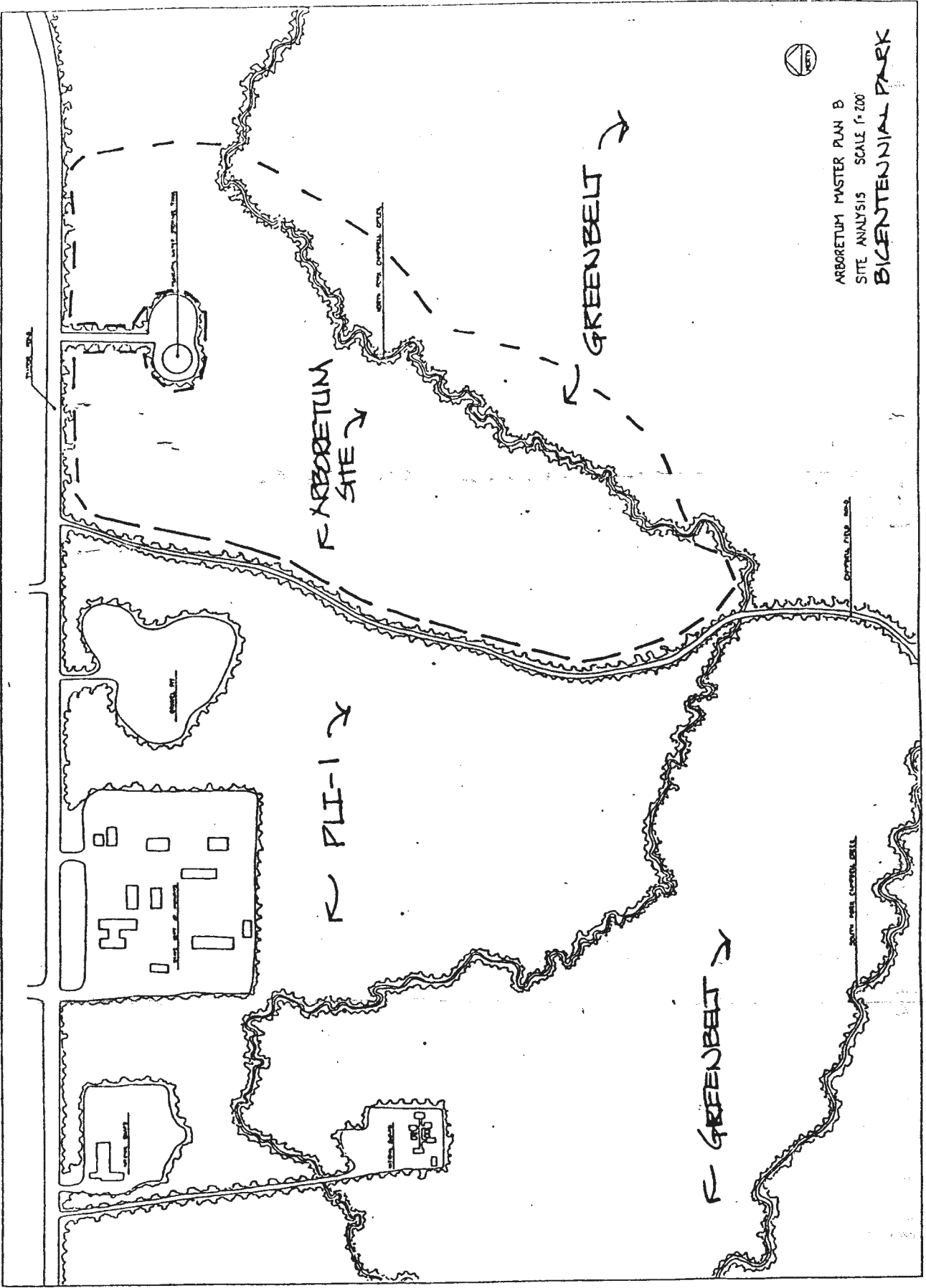

ARBORETUM MASTER PLAN B
 SITE ANALYSIS SCALE 1"=200'
 BICENTENNIAL PARK



ARBORETUM SITE

GREENBELT

GREENBELT

PLI-1

WATER CANAL

WATER CANAL

WATER CANAL

WATER CANAL

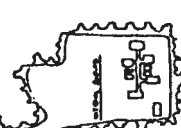
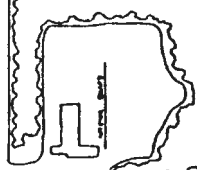
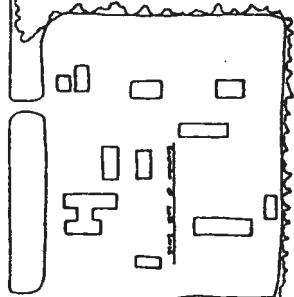
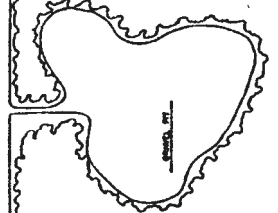

ANCHORAGE CHAPTER ELECTION--We were unable to conduct an election of officers at the December meeting due to lack of a quorum. The election, therefore, will be conducted at the January meeting. Listed below is the slate of officers as presented at the December meeting. Please place a check mark next to each name that you approve of, or write in a name of your own choosing. Mail ballot to the Society P.O. Box (to arrive not later than 15 January) or bring it with you to the January meeting.

OFFICIAL BALLOT

- PRESIDENT-----Verna Pratt
- VICE-PRESIDENT-----John Wenger
- SECRETARY-----Sandra Cosentino
- TREASURER-----Larry Heller
- REPRESENTATIVE TO STATE BOARD-----Frank Bogardus

MYSTERY PLANT ANSWER:
Anemone Richardsonii (Richardson's Anemone, Yellow Anemone)

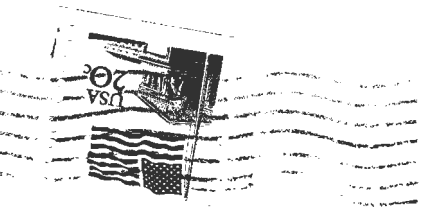

ALASKA NATIVE PLANT SOCIETY
P.O. BOX 8-737
ANCHORAGE, ALASKA 99508